



EUROLENS

2 to 12 Channel Expanded Beam Connector (Compatible with MIL-DTL-83526/20 & 21)



Key Features

- Expanded Beam technology
- Multimode & Singlemode Options
- Hermaphroditic Interface
- 2, 4, 8 & 12 channels available
- Compatible with MIL-DTL-83526/20 & 21
- Easy clean & maintain

The EUROLENS family of connectors are compatible with MIL-DTL-83526/20 & 21 and utilise expanded beam technology. Ideal for both Military and Industrial applications, these connectors have been designed for use in the most demanding harsh environment applications and provide the ultimate in reliable performance.

The Hermaphroditic coupling allows for rapid deployment, creating low loss Singlemode and Multimode links with the ability to daisy chain without the need for plugs and receptacles.

Benefitting from expanded beam technology, the design and packaging provides a robust connectivity solution resistant to corrosion, mechanical and thermal shock and offers ease of cleaning .

An example of some of the markets where EB Series are used:

- Deployable military tactical systems
 - Mobile tactical shelters
 - Security and surveillance
 - Emergency telecommunications stations
-

EUROLENS

2 to 12 Channel Expanded Beam Connector (Compatible with MIL-DTL-83526/20 & 21)

Lens Arrangement

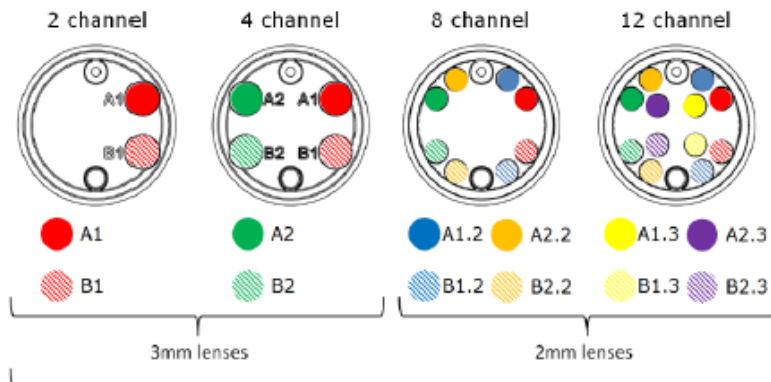

All versions are compatible !

Insertion Loss depending on lens-combination

	3mm ↔ 3mm	3mm ↔ 2mm	2mm ↔ 2mm
Typ. Loss MM @ 850/1300nm	≤ 0,8dB	≤ 1,5dB	≤ 0,8dB
Typ. Loss SM @ 1310nm / 1550nm	≤ 1,5dB	≤ 1,5dB	≤ 1,5dB

The EUROLENS system is the only expanded beam fiber optic connector system on the market where all 2 to 12 channel plugs and receptacles are fully compatible with each other.

Specification

	Multimode	Singlemode
Insertion Loss, typical	<0,8 dB @850/1300nm	<1.5 dB @1310nm/1550nm
Return Loss (mated)	>31 dB	>31 dB
Operating temperature	-55°C to +85°C	
Storage temperature	-55°C to +85°C	
Mating cycles	3,000 cycles	
Strain relief	1,500 N	
Immersion	15m, water (Plug and Receptacle)	
Protection Class	IP67 (mated or with dust cap)	

EUROLENS

2 to 12 Channel Expanded Beam Connector (Compatible with MIL-DTL-83526/20 & 21)

Dimensions

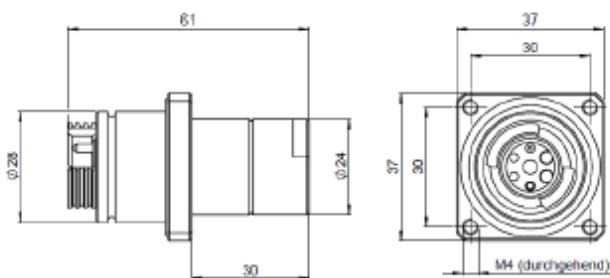
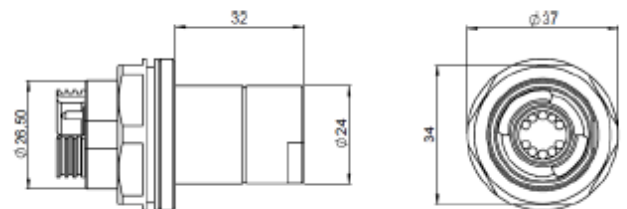
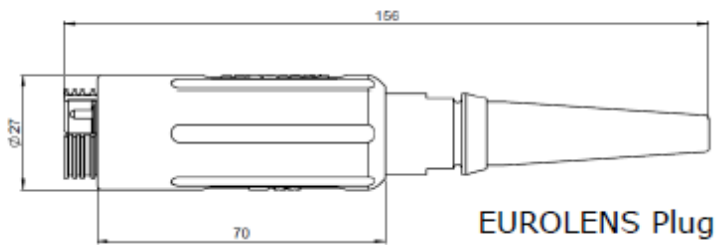

EUROLENS Plug



EUROLENS Receptacle
Flange Mount



EUROLENS Receptacle
Jam Nut Mount